



6800E



Vertical toggle clamp with blue handle

with open clamping arm and horizontal base.

Galvanized and passivated.

Rivets made of stainless steel, which, for sizes 2 to 6, run in hardened bushings.

Bearings are pre-lubricated.

Ergonomic, oil-resistant handle with large grip surface and soft components.

Safety clamping piece with finger protection, lock washer for the thrust bolt at the end of the clamping arm.

Complete with tempered, galvanized clamping screw no. 6890.

Part Number	Size	F1 [kN]	F2 [kN]	Clamping Screw	W (g)
557615	0	0.5	0.7	M4X25	60
557616	1	0.6	1.1	M5X30	105
557617	2	0.8	1.2	M6X25	175
557618	3	1.2	2.5	M8X45	410
557619	4	1.7	3.0	M8X65	630
557620	5	3.0	5.0	M12X80	1480
557621	6	3.4	6.5	M12X110	2200



DIMENSIONS

	A	B	C	D	E	F	H	H1	HW min	HW max	I	K	L	L1	L2	M	M1	N	P
0	4	31,0	8,5-13,5	4,5	14	5,5	18,0	81,0	-1,5	3,5	8	5,5	-	49	50	23,0	-	32	22
1	5	39,0	16,0	4,5	18	6,0	19,0	98,0	-4,0	2,0	10	5,5	-	61	58	22,5-26,0	-	34	27
2	6	52,0	20,0	5,5	25	11,0	23,0	140,0	-3,0	4,5	12	6,0	12,5	78	89	23,0-31,0	27	43	32
3	8	79,0	20,0	7,5	37	19,0	33,0	186,0	2,0	11,0	18	7,5	-	112	112	32,5	-	46	35
4	10	101,0	32,0	8,6	54	16,0	42,5	221,0	-6,0	22,5	20	13,0	-	141	130	43,0-46,5	-	64	53
5	14	140,0	45,0	8,5	73	34,0	55,8	281,0	-3,0	27,5	25	9,5	26,5-31,5	195	185	45,0-50,0	45	70	65
6	14	165,5	50,5	13,0	89	28,0	81,0	333,0	-2,5	55,0	30	24,5	-	231	206	67,5-72,5	-	100	90

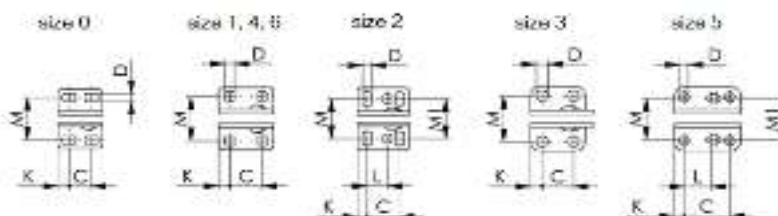
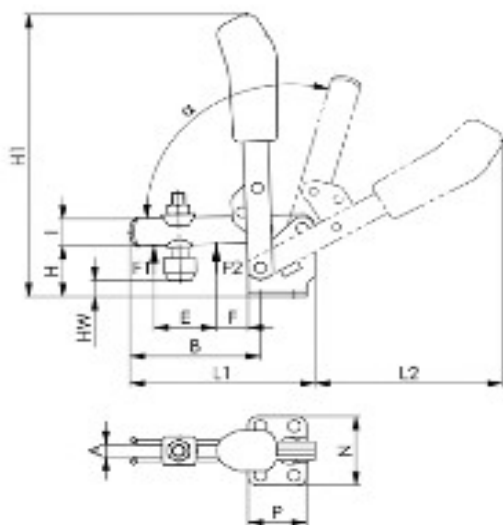

Matching accessories and similar products



Supporting arm for toggle clamps
No. 6895



Spring loaded screw
No. 6892



Vertical toggle clamp with red handle and safety latch