

No. 771

Adjustable hook wrench with nose

for grooved nuts to DIN 1804 and bearing nuts to DIN 981.

Special steel, hardened and **blued**.

Rounded edges for better handling.

Order no.	Size	L	T	Weight [g]
51201	20 - 42	180	4	100
51219	45 - 90	250	6	250
51227	95 - 165	335	10	710

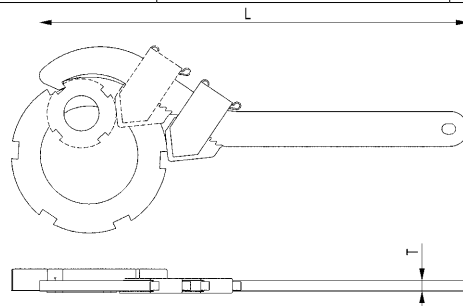

No. 771Md

Adjustable hook wrench with nose and torque wrench socket

for grooved nuts to DIN 1804 and bearing nuts to DIN 981.

Special steel, hardened and **blued**.

Drive: square socket

Order no.	Size	Drive SW [inch]	L	S	T	T1	Weight [g]
51516	20 - 42	1/2	135	100	4	16,0	165
51532	45 - 90	1/2	192	150	6	16,0	310
557065	95 - 165	1/2	272	200	10	16,0	680
51557	95 - 165	3/4	298	220	10	20,5	910

Note:

The set value for the torque wrench is dependant on insertion dimension „S“.

The operating manual provided with your torque wrench contains the requisite information and calculation formulae.

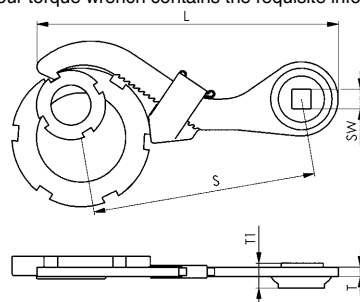

No. 776Md

Hinged hook wrench with pin and torque wrench socket

For nuts with radial holes to DIN 1816.

Special steel, hardened and **blued**.

Drive: square socket

Order no.	Size	Drive SW [inch]	dia. D	S	T	Weight [g]
52753	35-60	1/2	4	75	5	185
52761	60-90	1/2	6	100	6	320

Note:

The set value for the torque wrench is dependant on insertion dimension „S“.

The operating manual provided with your torque wrench contains the requisite information and calculation formulae.



Recommendations



No. 771Md,
page 50



No. 902Md,
page 58



No. 250Md,
page 58

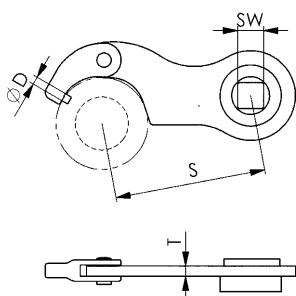

Subject to technical alterations.