

## Spring plungers with slot and thrust pin, LONG-LOK secured, steel

### Item description/product images



### Description

#### Material:

Sleeve steel grade 5.8.  
Thrust pin steel.  
Spring grade D steel wire.

LONG-LOK thread lock Nylon.

#### Version:

Black oxidised.  
Thrust pin hardened.

#### Drawing reference:

L2 = approx. 2x thread pitch

### Drawings

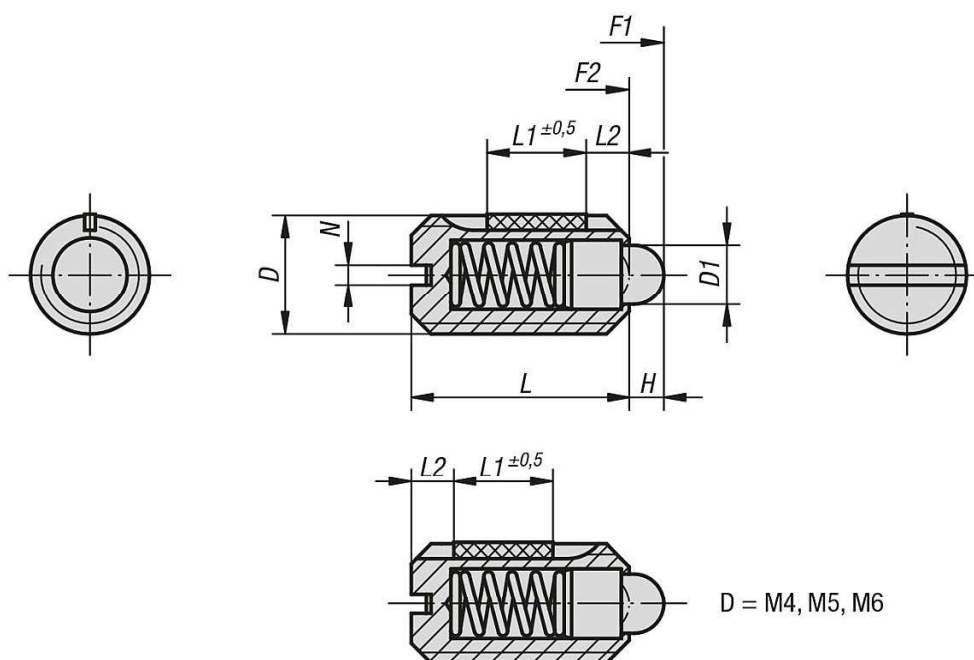

### Overview of items

#### Spring plungers with slot and thrust pin, standard spring force, LONG-LOK secured

Order No.	D	D1	H	L	L1	N	Spring force initial pressure F1 approx. N	Spring force final pressure F2 approx. N	Tightening torque approx. Nm	Loosening torque approx. Nm
K0323.04	M4	1,8	1,5	9	5	0,6	6	20	0,18	0,12
K0323.05	M5	2,4	2	12	6	0,8	6	20	0,12	0,08
K0323.06	M6	2,7	2	14	7	1	7	20	0,44	0,21
K0323.08	M8	4	2	16	8	1,2	15	30	1,1	0,38
K0323.10	M10	4,5	2,5	19	9	1,6	20	35	1,36	0,62
K0323.12	M12	6	3,5	22	10	2	30	55	2,11	1,41
K0323.16	M16	8,5	4,5	24	14	2,5	45	100	3,95	3,05

## Spring plungers with slot and thrust pin, LONG-LOK secured, steel

### Overview of items

Order No.	D	D1	H	L	L1	N	Spring force initial pressure F1 approx. N	Spring force final pressure F2 approx. N	Tightening torque approx. Nm	Loosening torque approx. Nm
K0323.104	M4	1,8	1,5	9	5	0,6	3	10	0,18	0,12
K0323.105	M5	2,4	2	12	6	0,8	3	10	0,12	0,08
K0323.106	M6	2,7	2	14	7	1	4	10	0,44	0,21
K0323.108	M8	4	2	16	8	1,2	7	15	1,1	0,38
K0323.110	M10	4,5	2,5	19	9	1,6	9	16	1,36	0,62
K0323.112	M12	6	3,5	22	10	2	14	26	2,11	1,41
K0323.116	M16	8,5	4,5	24	14	2,5	22	50	3,95	3,05
K0323.205	M5	2,4	2	12	6	0,8	9	25	0,12	0,08
K0323.206	M6	2,7	2	14	7	1	11	25	0,44	0,21
K0323.208	M8	4	2	16	8	1,2	22	43	1,1	0,38
K0323.210	M10	4,5	2,5	19	9	1,6	20	54	1,36	0,62
K0323.212	M12	6	3,5	22	10	2	36	94	2,11	1,41
K0323.216	M16	8,5	4,5	24	14	2,5	60	110	3,99	3,05

### Spring plungers with slot and thrust pin, light spring force, LONG-LOK secured

Order No.	D	D1	H	L	L1	N	Spring force initial pressure F1 approx. N	Spring force final pressure F2 approx. N	Tightening torque approx. Nm	Loosening torque approx. Nm
K0323.104	M4	1,8	1,5	9	5	0,6	3	10	0,18	0,12
K0323.105	M5	2,4	2	12	6	0,8	3	10	0,12	0,08
K0323.106	M6	2,7	2	14	7	1	4	10	0,44	0,21
K0323.108	M8	4	2	16	8	1,2	7	15	1,1	0,38
K0323.110	M10	4,5	2,5	19	9	1,6	9	16	1,36	0,62
K0323.112	M12	6	3,5	22	10	2	14	26	2,11	1,41
K0323.116	M16	8,5	4,5	24	14	2,5	22	50	3,95	3,05

### Spring plungers with slot and thrust pin, reinforced spring force, LONG-LOK secured

Order No.	D	D1	H	L	L1	N	Spring force initial pressure F1 approx. N	Spring force final pressure F2 approx. N	Tightening torque approx. Nm	Loosening torque approx. Nm
K0323.205	M5	2,4	2	12	6	0,8	9	25	0,12	0,08
K0323.206	M6	2,7	2	14	7	1	11	25	0,44	0,21
K0323.208	M8	4	2	16	8	1,2	22	43	1,1	0,38
K0323.210	M10	4,5	2,5	19	9	1,6	20	54	1,36	0,62
K0323.212	M12	6	3,5	22	10	2	36	94	2,11	1,41
K0323.216	M16	8,5	4,5	24	14	2,5	60	110	3,99	3,05