

## Clamping lever, die-cast zinc with extended collar with male thread, steel parts stainless steel

Item description/product images



### Description

#### Product description:

The clamping lever with extended collar replaces the screw on e.g. tube clamps. This enables tool-free tightening and loosening of the screw connection. The die-cast zinc clamping lever with its ergonomic handle design has a modern high-quality appearance and provides comfortable haptics.

#### Material:

Grip lever die-cast zinc DIN EN 12844.  
Steel parts stainless steel 1.4305.

#### Version:

Grip lever and steel parts bright.

#### Note:

A recommendation for the suitable clamping lever is given in the tube clamp dimension tables.

#### Advantages:

Tool-free clamping and releasing of tube clamps

#### On request:

Other threads, screw lengths, colours and special versions.  
Dimension "H1" available in other lengths at extra charge.

#### Accessory:

For tube clamps

#### Drawing reference:

1) DIN EN ISO 4753 flat point

# Clamping lever, die-cast zinc with extended collar with male thread, steel parts stainless steel

Item description/product images

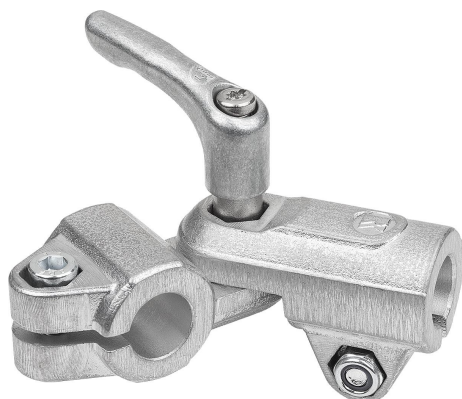

## Drawings

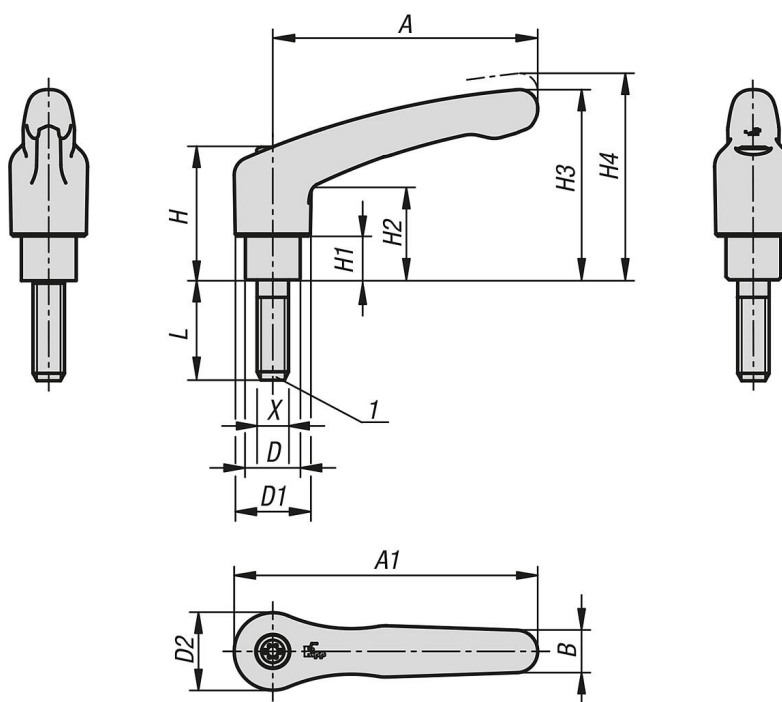

## Overview of items

### Clamping lever, die-cast zinc with extended collar, with male thread, steel parts stainless steel

Order No.	Size	A	A1	B	D	D1	D2	H1	H2	H3	H4	L	X	Thread type	No. of teeth
K0123.106108X18	1	40	47	7	10	13	14	10	20,5	37	40	18	M6	external thread	16
K0123.106108X20	1	40	47	7	10	13	14	10	20,5	37	40	20	M6	external thread	16
K0123.208148X25	2	65	74,5	9,5	13	18,5	19	14	25	50	53	25	M8	external thread	20
K0123.310148X30	3	80	91	11	16	21	22	14	28	58,5	62,5	30	M10	external thread	22
K0123.310148X35	3	80	91	11	16	21	22	14	28	58,5	62,5	35	M10	external thread	22

## **Clamping lever, die-cast zinc with extended collar with male thread, steel parts stainless steel**

Overview of items

---