

Plastic cylindrical grips, revolving, with external thread

Item description/product images



Description

Product description:

Cylindrical grips are supplied assembled and can be screwed onto handwheels, crank handles, etc.

The grooves and conical shape ensure that the cylindrical grips have optimised haptics and good grip.

Material:

Grip thermoplastic.

Centre pin steel grade 5.8 or stainless steel 1.4404.

Version:

Grip, black.

Steel parts, black oxidised.

Stainless steel bright.

Advantages:

Optimised haptics and good grip

Grips for handwheels and cranks

Various thread sizes

NOVO grip KIPP design

Drawings

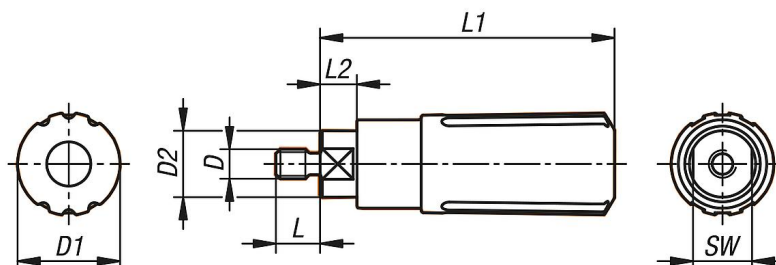

Overview of items

Order No.	Thread type	Component material	Size	D	D1	D2	L	L1	L2	SW
K1468.104	external thread	steel	1	M4	14	9	6	40	5	8
K1468.205	external thread	steel	2	M5	16	11	7,5	49,1	5,1	10
K1468.306	external thread	steel	3	M6	20	14	9	61,4	6,4	12
K1468.408	external thread	steel	4	M8	25	18	12	82,5	12,5	15
K1468.2104	external thread	stainless steel	1	M4	14	9	6	40	5	8
K1468.2205	external thread	stainless steel	2	M5	16	11	7,5	49,1	5,1	10
K1468.2306	external thread	stainless steel	3	M6	20	14	9	61,4	6,4	12
K1468.2408	external thread	stainless steel	4	M8	25	18	12	82,5	12,5	15